

A dynamic workspace
with wellbeing in its soul.

DUO

SPITALFIELDS

Space plans

Dedicated and Shared Reception Ground Floor

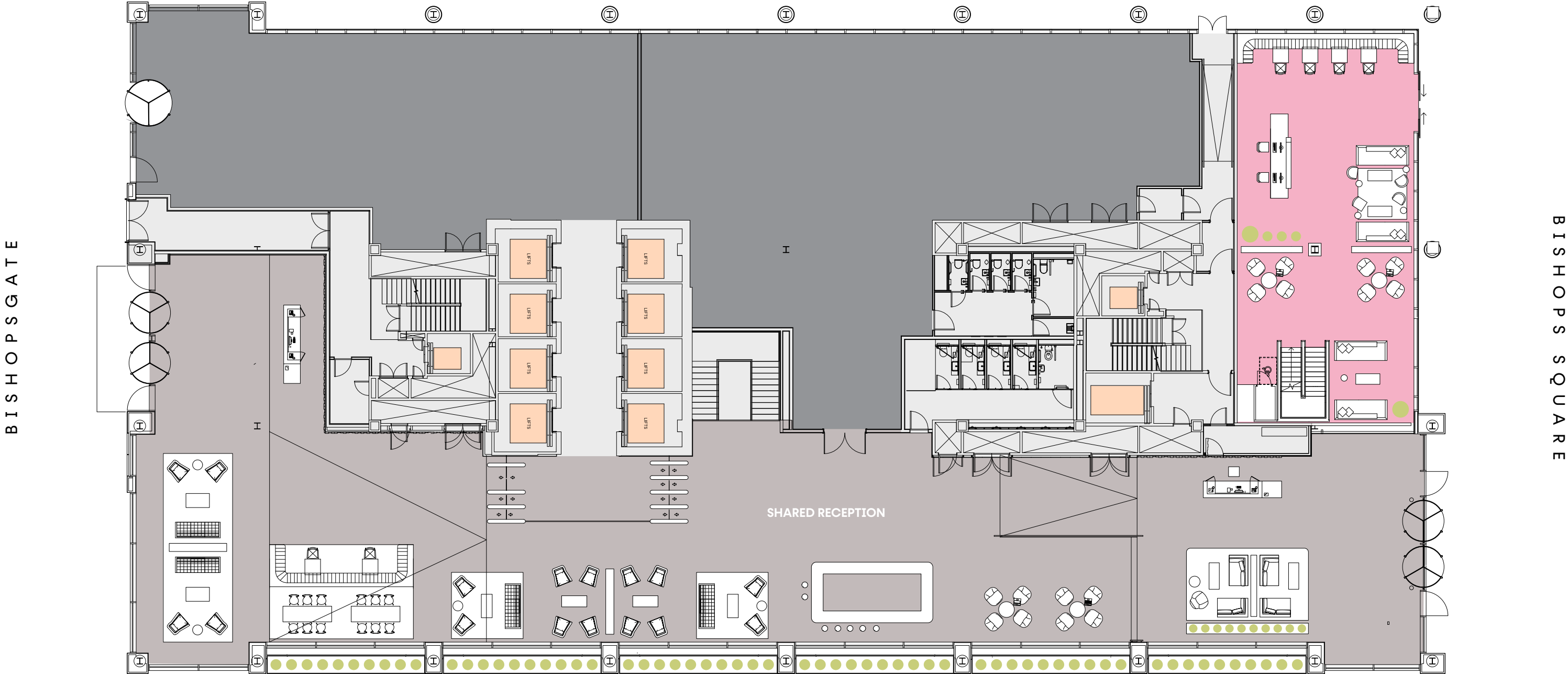

KEY

- Shared Reception
- LET
- Private Reception
- Core

Not to scale. For indicative purposes only.

SHARED RECEPTION		DEDICATED RECEPTION	
Informal meeting / Breakout seats	54	Informal meeting / Breakout seats	32
Agile Desks	24		



General Layout with Meeting Suite

Level 1

DUO
SPITALFIELDS

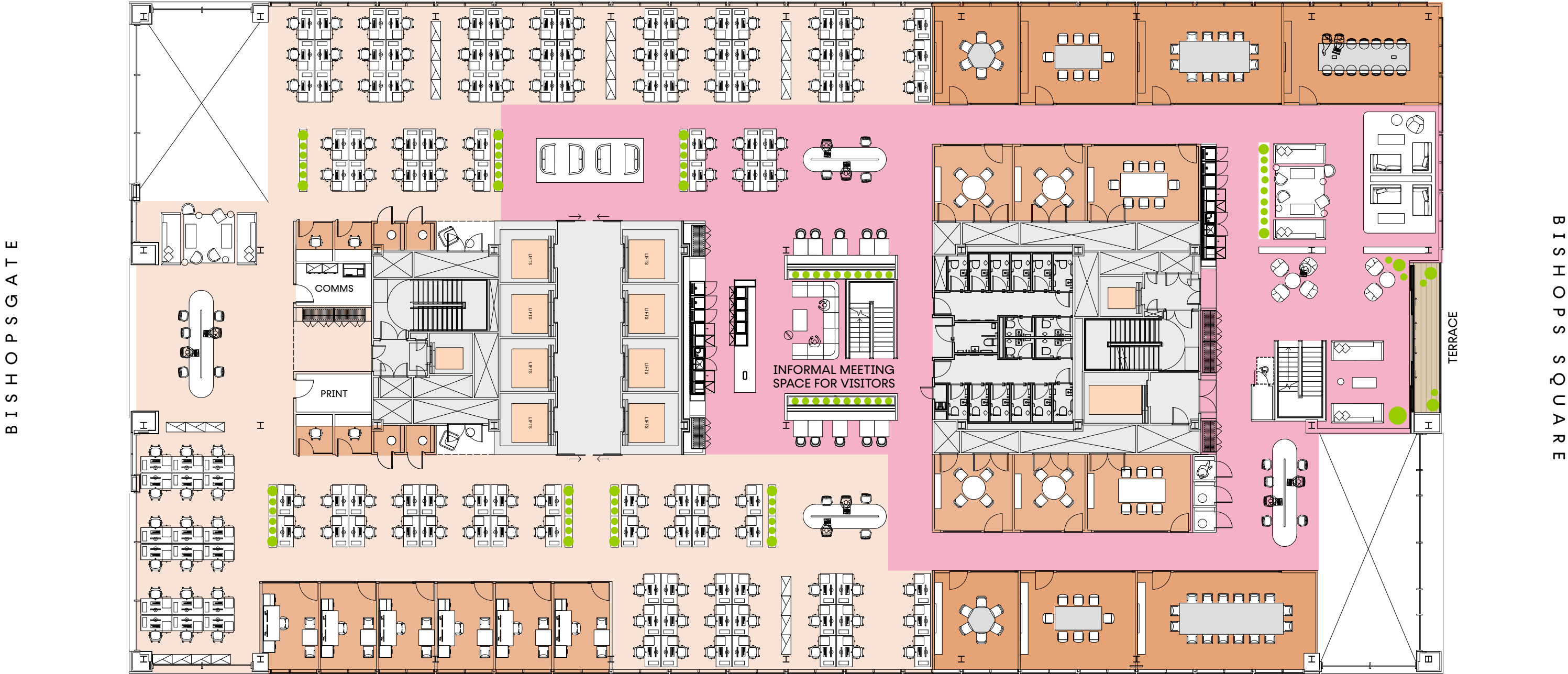

KEY

- Meeting Room
- Office and Desk
- Breakout/ Informal Space
- Open Plan
- Core

Not to scale. For indicative purposes only.

NIA / RATIO		WORKSTATIONS		MEETING		OTHER	
NIA	1849.9 sqm	Offices	6	16 pple Meeting Room	1	Teapoint/ Breakout	2
Total Desks	154	Open Plan Desks	124	14 pple Meeting Room	1	Comms	1
Ratio	1:12	Agile Desks	24	12 pple Meeting Room	1	Print	1
				8 pple Meeting Room	2		
				6 pple Meeting Room	3		
				4 pple Meeting Room	4		
				1 Person quiet room / phone booth	11		



General Layout

Level 2

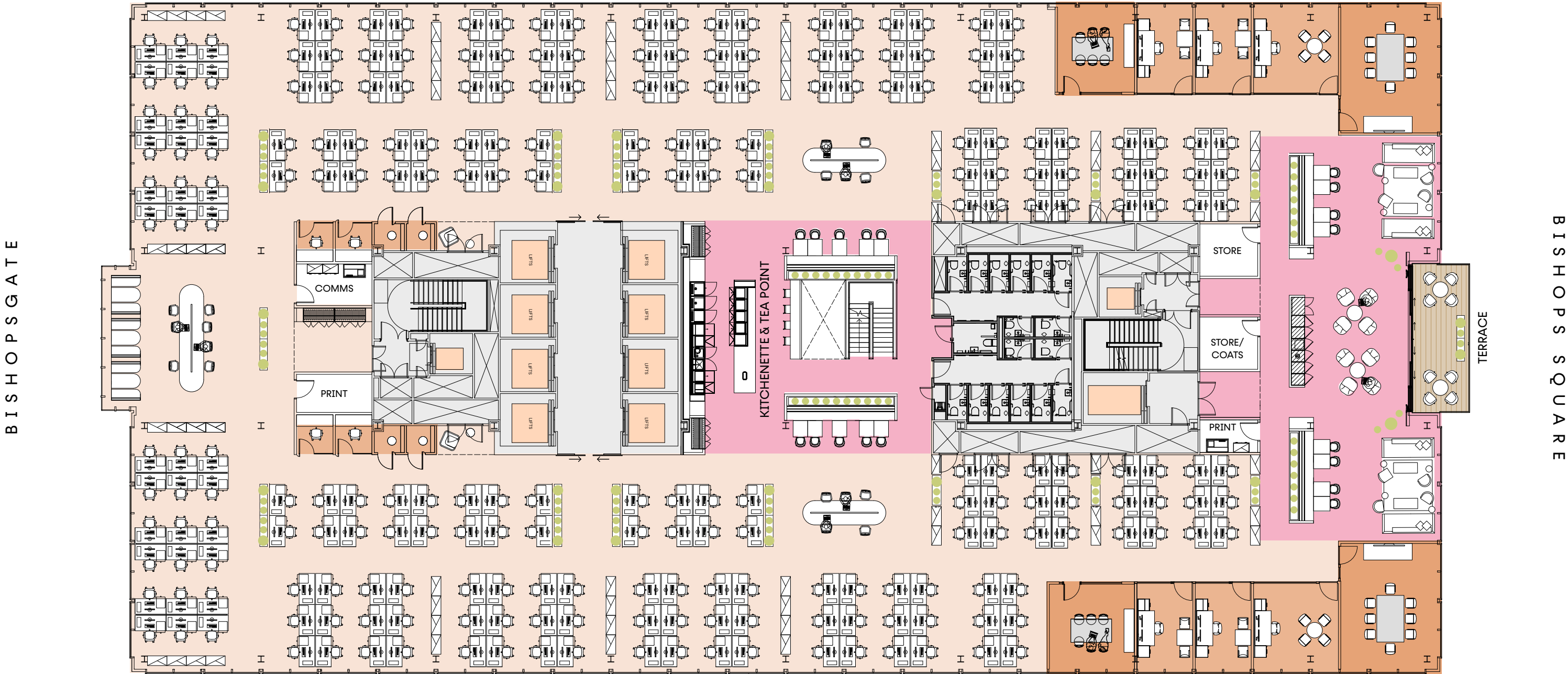

KEY

- Meeting Room
- Office and Desk
- Breakout/ Informal Space
- Open Plan
- Core

Not to scale. For indicative purposes only.

NIA / RATIO		WORKSTATIONS		MEETING		OTHER	
NIA	1969.8 sqm	Offices	6	8 pple Meeting Room	2	Teapoint / Breakout	2
Total Desks	283	Open Plan Desks	260	6 pple Meeting Room	2	Comms	1
Ratio	1:6.9	Agile Desks	17	1 Person quiet room / phone booth	4	Print	2
						Store	2



General Layout – Enhanced Agile Option

Level 2

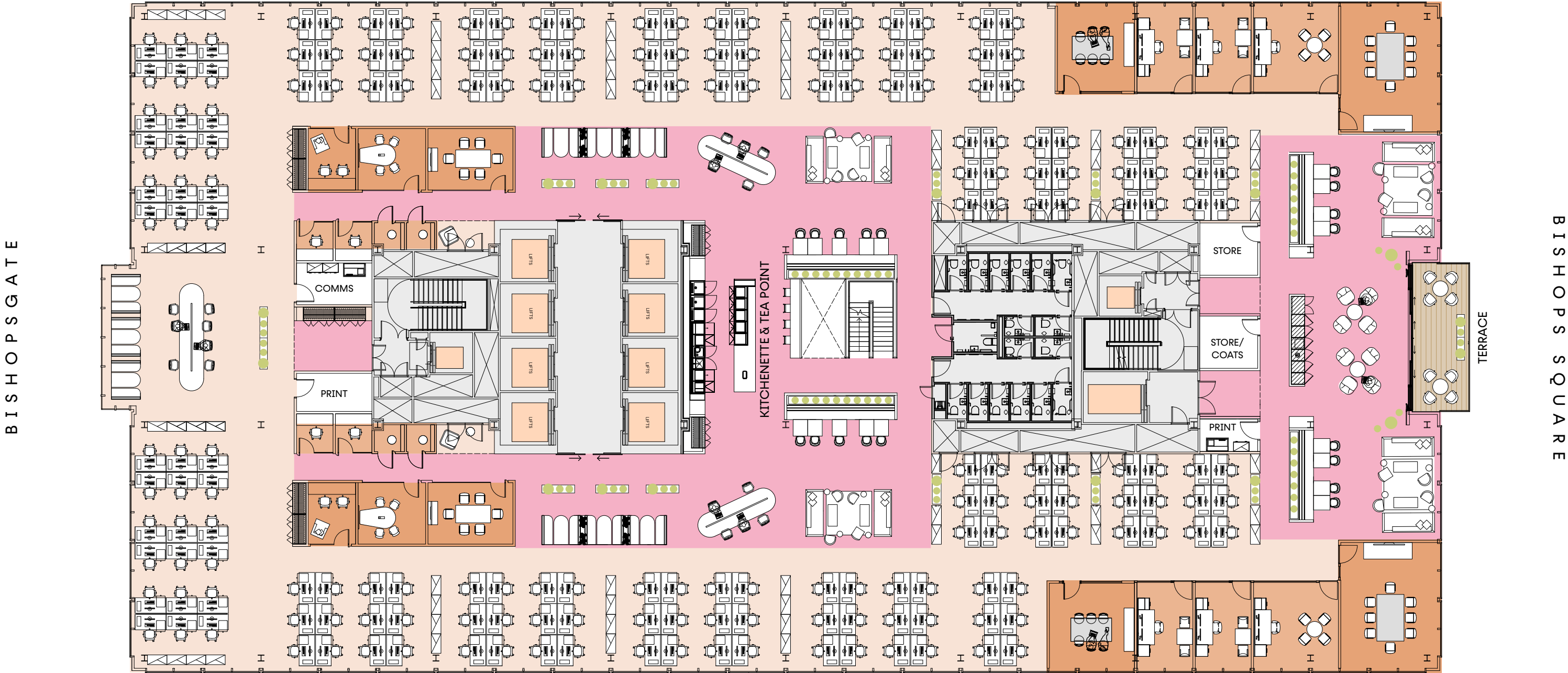

KEY

- Meeting Room
- Office and Desk
- Breakout/ Informal Space
- Open Plan
- Core

Not to scale. For indicative purposes only.

NIA / RATIO		WORKSTATIONS		MEETING		OTHER	
NIA	1969.8 sqm	Offices	6	8 pple Meeting Room	2	Teapoint/ Breakout	2
Total Desks	260	Open Plan Desks	198	6 pple Meeting Room	4	Comms	1
Ratio	1: 7.5 <small>(inc. all alternative/ agile settings)</small>	Alternative Agile work points	56	4 pple Meeting Room	2	Print	2
				1 Person quiet room / phone booth	4	Store	2



General Layout

Level 3

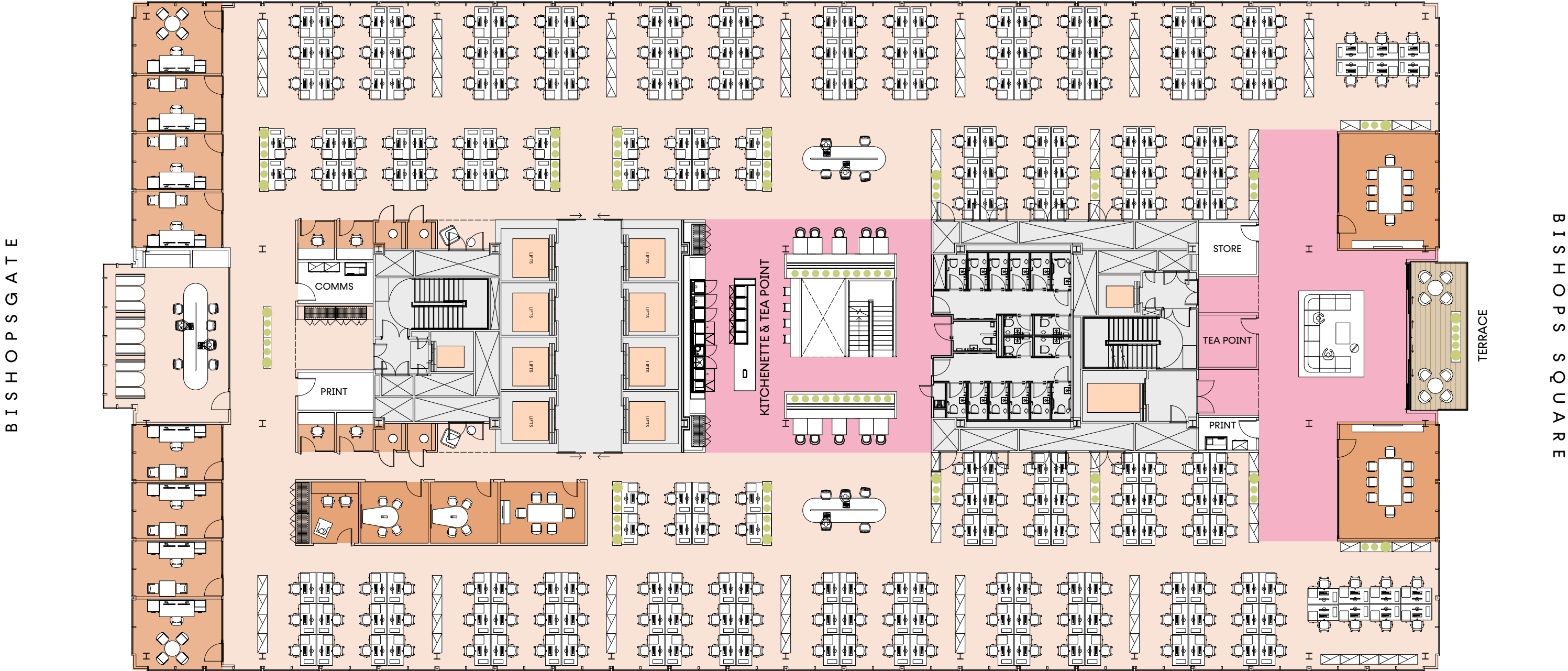

KEY

- Meeting Room
- Office and Desk
- Breakout/ Informal Space
- Open Plan
- Core

Not to scale. For indicative purposes only.

NIA / RATIO		WORKSTATIONS		MEETING		OTHER	
NIA	1969.8 sqm	Offices	8	14 pple Meeting Room	1	Teapoint/ Breakout	2
Total Desks	253	Open Plan Desks	238	8 pple Meeting Room	2	Comms	1
Ratio	1:8	Agile Desks	17	6 pple Meeting Room	1	Print	2
				4 pple Meeting Room	2	Store	1
				1/2 Person quiet room/ phone booth	5		



General Layout

Level 4

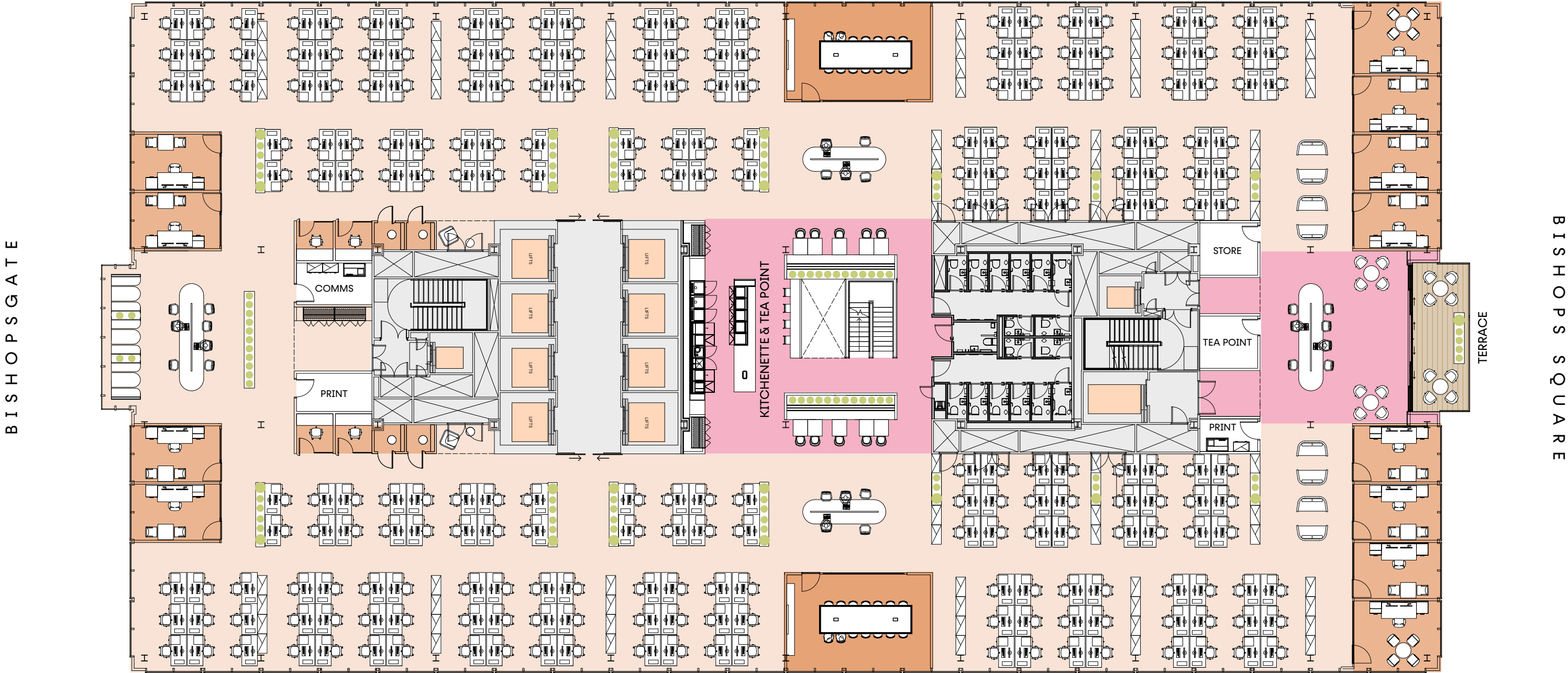

KEY

- Meeting Room
- Office and Desk
- Breakout/ Informal Space
- Open Plan
- Core

Not to scale. For indicative purposes only.

NIA / RATIO		WORKSTATIONS		MEETING		OTHER	
NIA	1969.8 sqm	Offices	12	14 pple Meeting Room	2	Teapoint / Breakout	2
Total Desks	253	Open Plan Desks	234	1 Person quiet room / phone booth	4	Comms	1
Ratio	1:8	Agile Desks	17			Print	2
						Store	1



General Layout

Level 5

DUO
SPITALFIELDS

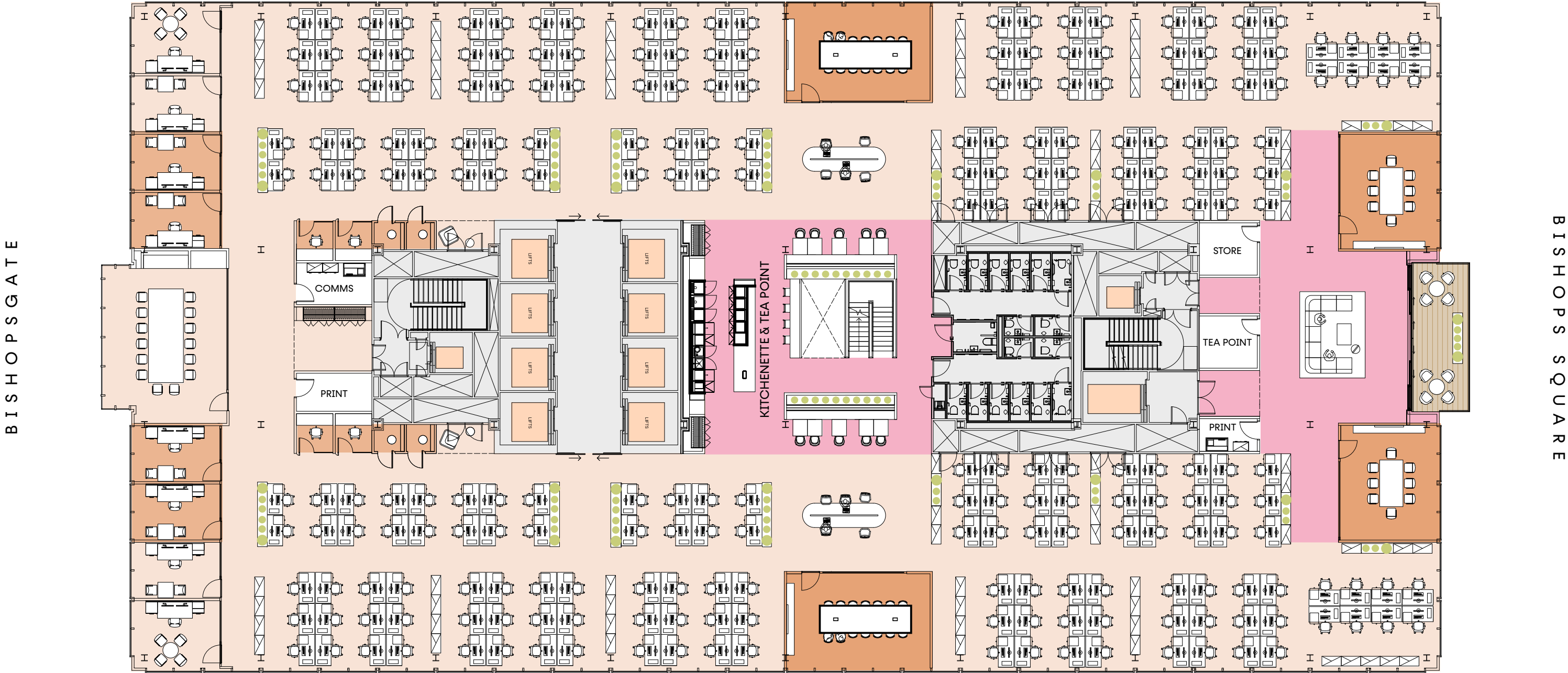

KEY

- Meeting Room
- Office and Desk
- Breakout/ Informal Space
- Open Plan
- Core

Not to scale. For indicative purposes only.

NIA / RATIO		WORKSTATIONS		MEETING		OTHER	
NIA	1969.8 sqm	Offices	8	14 pple Meeting Room	3	Teapoint / Breakout	2
Total Desks	253	Open Plan Desks	238	1 Person quiet room / phone booth	4	Comms	1
Ratio	1:8	Agile Desks	17			Print	2
						Store	1



General Layout

Level 6

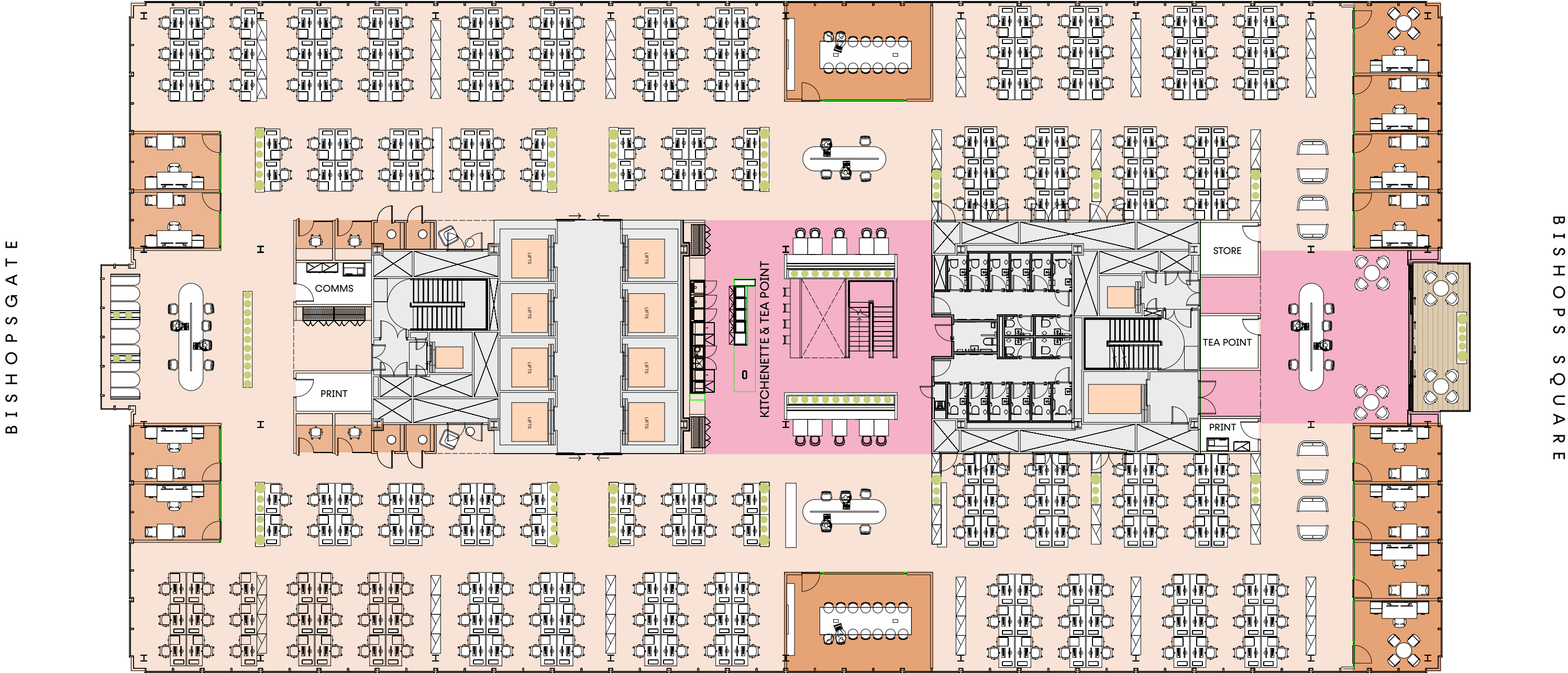

KEY

- Meeting Room
- Office and Desk
- Breakout/ Informal Space
- Open Plan
- Core

Not to scale. For indicative purposes only.

NIA / RATIO		WORKSTATIONS		MEETING		OTHER	
NIA	1969.8 sqm	Offices	12	14 pple Meeting Room	2	Teapoint/ Breakout	2
Total Desks	253	Open Plan Desks	234	1 Person quiet room / phone booth	4	Comms	1
Ratio	1:8	Agile Desks	17			Print	2
						Store	1



DUO

SPITALFIELDS



Sam Boreham
+44 (0)7917 635 465
SamB@bh2.co.uk

Dan Roberts
+44 (0)7801 143 909
danr@bh2.co.uk

Jack Beeby
+44(0)7841 802 097
jackb@bh2.co.uk



Tim Plumbe
+44 (0)7768 146 280
tim.plumbe@cushwake.com

Eleanor Reed
+44 (0)20 3296 2080
eleanor.reed@cushwake.com

Matt Waugh
+44 (0) 7912 977 980
matt.waugh@cushwake.com

Richard Howard
+44 (0)7764 810 217
richard.howard@cushwake.com



Chris Vydra
+44 (0)7710 618 023
chris.vydra@cbre.com

David Perowne
+44 (0)7739 814 720
david.perowne@cbre.com

Adam Cosgrove
+44 (0) 7500 872 851
adam.cosgrove@cbre.com

HELLODUO.LONDON

Important notice relating to the Misrepresentation Act 1967 and the Property Misdescriptions Act 1991: (i) the particulars are set out as a general outline only for guidance of intending lessees and do not constitute, nor constitute part of, an offer or contract (ii) all descriptions, dimensions, references to condition and necessary permission for use and occupation, and other details are given in good faith and are believed to be correct at the time of publication, and are subject to any necessary third party consents. The developer reserves the right to evolve design through to delivery of the project. Any intending occupiers should not rely on them as statements or representations of fact, but must satisfy themselves by inspection and taking other professional advice as to the correctness of each of them. CGI renders are shown for illustrative purposes only. November 2020. November 2020. Designed by Saentys +44 (0)20 7407 8717 www.saentys.com | Document reference No. 00212020